

Description

The Qualifiltres range QLINOX filter is a large dimension cartridge filter designed for the industrial sector.

It's molded design includes swing bolt closing and DN50 PN16 flanges connection.

The lid is equipped with a ¼" BSP connection for the mounting of a vent valve or manometer and a ½" connection for the mounting of drain valve.

The surface is electropolished in order to facilitate the cleaning and resistance to corrosion.

The filters body works with 20" and 30" Filtech Highflow cartridges reducing filtration and intervention costs.

The great filtration area of the Filtech Highflow cartridges enables very low pressure drop and great retention capacities.

Characteristics & advantages

- Quick closing with swing bolts (BB) for a better resistance to pressure.
- Available in 2 materials: 304 or 316L
- Available in 2 heights: 20" and 30"
- The L-TECH Pleated filtration cartridge possesses a very large filtration area (2,5m²/10"). See Filtech technical data sheet.
- Maintenance intervention simplified thanks to the L-TECH Highflow technology.
Filtration and intervention costs reduction.
- Filtration flow rate between 10 and 40 m³/h
- Lid gaskets :
 - EPDM (Ref : SI16655).
 - FPM (Ref: SI16656)
- Options available on demand :
 - Manometer, Stainless steel 316L draining and venting valves (Ref: SI16442)
 - Can work with 7 standard cartridges (e.g. Qualitherm or Qualibob)
- Other ends and conceptions available on demand

Service conditions

- Max working pressure: 10 bar at 75°C
- Can handle up to 15 bar at 100°C



ORDER REFERENCES

REFERENCE QLINOX - [20] - [B50] - [304] - [E]
Tab 1 Tab 2 Tab 3 Tab 4

Table 1 : Filter body size

Code	Description
20	20"
30	30"

Table 2 : Inlet / outlet

Code	Description
B50	DN 50 Flange
2	2" BSP Female

Table 3 : Materials

Code	Description
304	Stainless steel 304
316	Stainless steel 316L

Table 4 : Gasket

Code	Description
E	EPDM
V	FPM

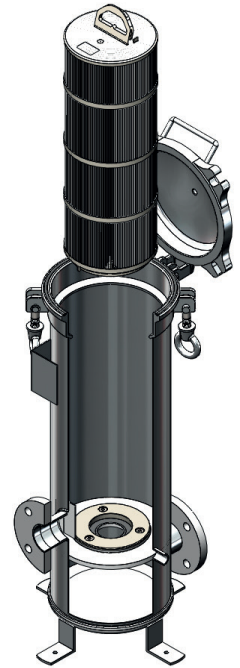
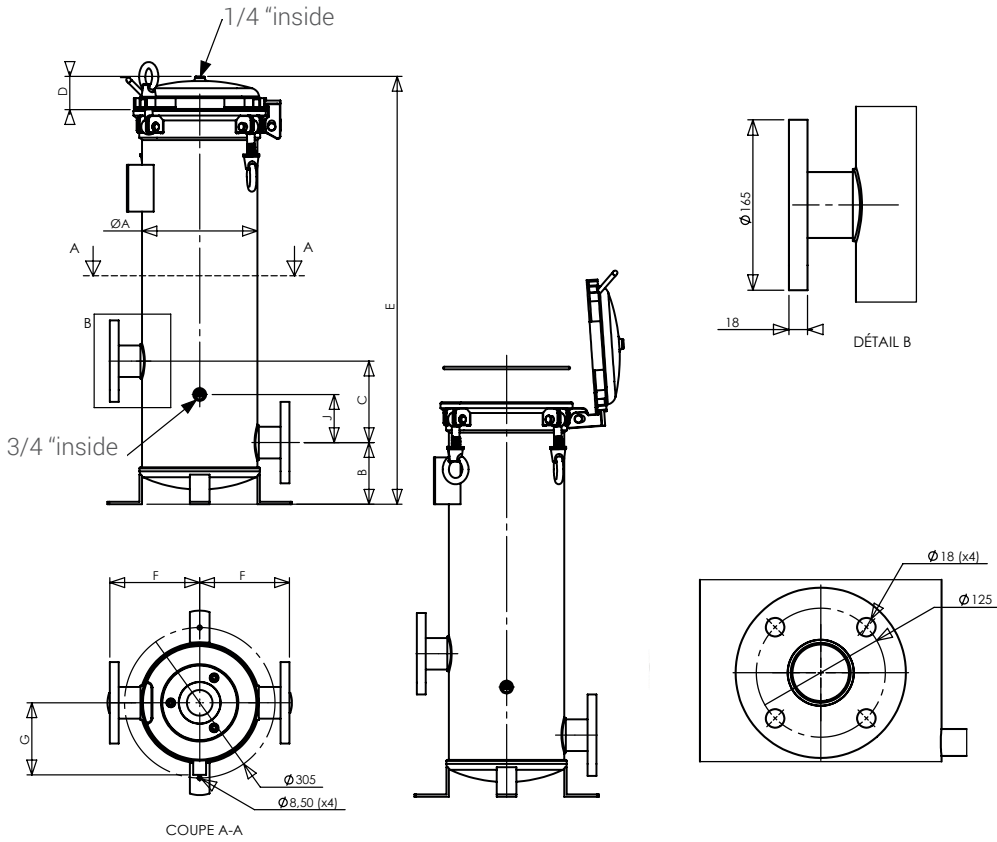

Modèle	A(mm)	B(mm)	C(mm)	D(mm)	E(mm)	F(mm)	G(mm)	J(mm)
QLINOX 20"	Ø234	675	510	67	867	182	146	577
QLINOX 30"	Ø234	925	760	67	1117	182	146	827

TYPICAL FLOW RATE : for 20" QLinox, deflectors 2" In/Out

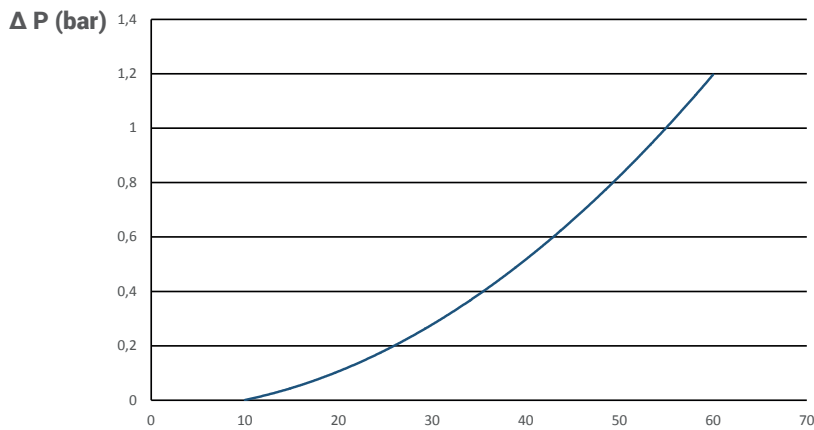

typical initial pressure loss,
water at 20°C, 1cP viscosity

Flow rate (m³/h)